

CTI Janus Workbench Digital License Installation

Follow the steps below to activate the CTI Janus Workbench Digital License:

1. Install Janus Workbench v1.78 or higher.
2. Start Janus Workbench and close any CTI dialogs that are displayed. Janus Workbench should open in DEMO mode.
3. Click on the Help Menu Item and select the **ABOUT** option to open the **About** dialog box shown below.



4. Click on the **ACTIVATION CODE** button to open the **Activation Code** dialog box shown below.

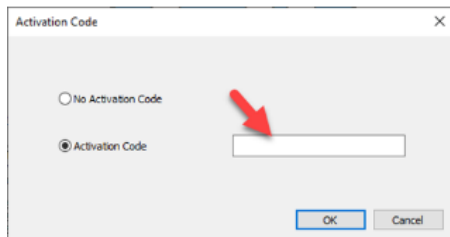

5. Select the **ACTIVATION CODE** radio button and enter your activation code. Then click on the **OK** button, which will open the **Confirmation** dialog box shown below.

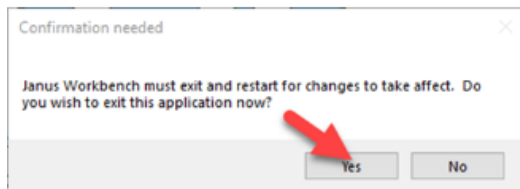

6. Click on the **YES** button to confirm changes. Janus Workbench will close at this point.
7. Start the Janus Work Workbench application and verify that it doesn't start in DEMO mode.